

LOT 26  
LOT 25

MEASUREMENTS SHOWN HEREON ARE BASED ON A CONTROL TRAVERSE WITH ELECTRO-OPTICAL INSTRUMENTS PRECISE TO 5 SECONDS OF ARC (0'00'05") AND 0.01 FEET. SURVEY AND MAP FOLLOW STANDARDS OF THE NIAGARA FRONTIER LAND SURVEYORS' ASSOCIATION.

WARNING: STATEMENTS AS TO THE STATUS OF A SURVEY (CHANGE OR NO CHANGE) CAN BE MADE ONLY BY A PRACTICING, LICENSED SURVEYOR WHO HAS SUPERVISED A FIELD CREW TO INSPECT PREMISES AND COMPARE SAME WITH THE CURRENT DEED OF RECORD. UNAUTHORIZED ALTERATION HERETO OR PLAGIARISM HEREOF, MAY BE A VIOLATION OF NEW YORK STATE LAW OR REGULATION. ORIGINAL SURVEYOR'S PRINTS OF THIS DRAWING BEAR (1) THE SURVEYOR'S SIGNATURE (2) THE SURVEYOR'S CIRCULAR STAMP AND (3) THE SURVEYOR'S CIRCULAR, EMBOSSED SEAL.



L25  
T5  
R11

- KEY**
- = Existing Iron Pin
  - = Iron Pin Set
  - ⊙ = Pole

GRISWOLD ROAD

S.L.N. BYRON ABELL, (N/F)  
N.L.N. KNOTT TO HOISINGTON,  
AND N.L.N. HOISINGTON TO GRISWOLD,  
APRIL 1, 1868, 128/259

637.1'R.,M.  
600'

(8.38=553.1'R)  
±550'R

76.8'R.,M.  
86°11'

PROPOSED ±2.75 AC.

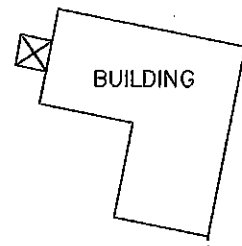

POND

PROPOSED BOUNDARY LINES  
SUBJECT TO REGULATION AS  
MAY BE REQUIRED.

FIRSTLY DESCRIBED  
DERKOVITZ TO  
DERKOVITZ. 2489/407

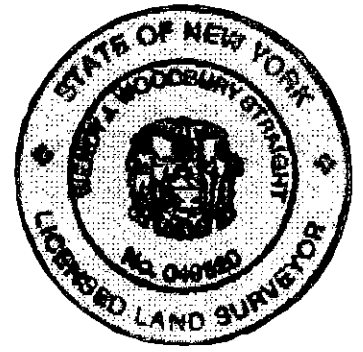

DRAWING OF  
BOUNDARY SURVEY  
PORTION OF PROPERTY OF  
PAUL F. and SANDRA L. DERKOVITZ  
Town of Arkwright  
Chautauqua County New York  
Scale: 1" = 60' September 19, 2002  
Land Surveyor, NYS Lic. No. 49520

6/13/11